

SUBMERSIBLE PUMP

Submersible pumps Compact design, high performance and exceptional durability for handling abrasive liquid, widely used in general construction and civil engineering.

The body of motor and pump is made from cast iron or stainless steel for long-lasting durability.

Greatly increased maximum submersion depth due to mechanical seal resistant to high pressure (0.5 Mpa).

60Hz - Technical parameter

Model	Voltage	Frequency	Power		Current	H.Max	Q.Max	Size	G.W
	V	Hz	kW	HP	Amp	m	m³/h	Inch	Kg
KSM21.5(F)	220	60	1.5	2	10	22	27	NPT2"	37
KSM31.5(F)	220	60	1.5	2	10	14	42	NPT3"	37
KS21.5	380	60	1.5	2	3.5	22	27	NPT2"	37
KS21.5F	380	60	1.5	2	3.5	22	27	NPT2"	39
KS31.5	380	60	1.5	2	3.5	14	42	NPT3"	37
KS31.5F	380	60	1.5	2	3.5	14	42	NPT3"	39
KS22.2	380	60	2.2	3	5.1	26	31	NPT2"	40
KS22.2F	380	60	2.2	3	5.1	26	31	NPT2"	42
KS32.2	380	60	2.2	3	5.1	19	47	NPT3"	40
KS32.2F	380	60	2.2	3	5.1	19	47	NPT3"	42
KS23.7	380	60	3.7	5	8.0	32	42	NPT2"	58
KS23.7F	380	60	3.7	5	8.0	32	42	NPT2"	60
KS33.7	380	60	3.7	5	8.0	31	57	NPT3"	58
KS33.7F	380	60	3.7	5	8.0	31	57	NPT3"	60
KS43.7	380	60	3.7	5	8.0	18	95	NPT4"	59
KS43.7F	380	60	3.7	5	8.0	18	95	NPT4"	61
KS35.5	380	60	5.5	7.5	11.6	38	69	NPT3"	69
KS35.5F	380	60	5.5	7.5	11.6	38	69	NPT3"	68
KS45.5	380	60	5.5	7.5	11.6	23	105	NPT4"	67
KS45.5F	380	60	5.5	7.5	11.6	23	105	NPT4"	69

H(m) PERFORMANCE CHART AT n=3450min⁻¹

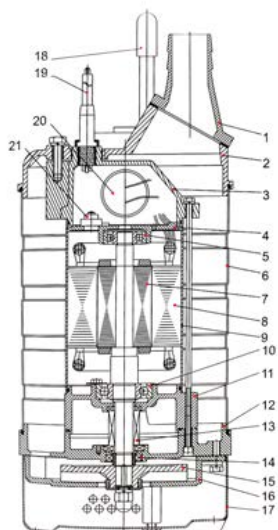
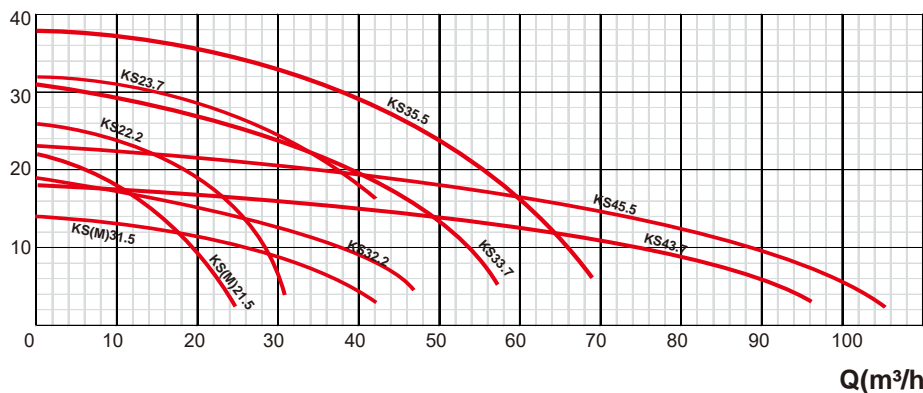

EXPLODED VIEW DRAWING - SPARE PARTS

No.	Description	No.	Description
1	Hose coupling	12	Plate
2	Upper cover	13	Mechanical seal
3	Motor cover	14	Oil seal bracket
4	Bearing house	15	Impeller
5	Bearing	16	Pump body
6	Pump casing	17	Filter
7	Rotor	18	Handle
8	Stator	19	Cable
9	Motor body	20	Capacitor
10	Bearing	21	Motor protector
11	Bearing house		

available also in 50Hz